

FOUNDATION PLAN

S.1

SCALE: 1/4" = 1'-0"

GENERAL NOTES

1. THE CONTRACTOR AND ALL SUBCONTRACTORS SHALL VERIFY ALL DIMENSIONS AND CONDITIONS AT THE SITE, AND NOTIFY THE OWNER AND BLUEFEATHER DESIGN/BUILD OF ANY DISCREPANCY.
2. ALL WORKMANSHIP AND BUILDING MATERIALS SHALL CONFORM TO THE CURRENT LOCAL AND INTERNATIONAL BUILDING CODES THAT APPLY.
3. ALL PLUMBING, MECHANICAL, AND ELECTRICAL WORK MUST BE DONE BY LICENSED CONTRACTORS.
4. ALL EXTERIOR HOUSE WALLS ARE 2X6 WALL TYPICAL WALL CONSTRUCTION. ALL INTERIOR WALLS ARE 2X4 AND 2X6 WALL CONSTRUCTION. PLEASE ____ R.O.'S WHEN CONSTRUCTING HOUSE.

FOUNDATION NOTES

1. CONCRETE MIX SHALL HAVE A MINIMUM ULTIMATE COMPRESSIVE STRENGTH OF 3000 PSI AT 28 DAYS.
2. FOOTINGS SHALL BE #2 THICK BY 16" WIDE. FOOTING DESIGN BASED ON SOIL BEARING PRESSURE OF 2000 PSI. CONTRACTOR MUST INCREASE FOOTING SIZE IF THE MINIMUM S.B.P. IS NOT MET.
3. ALL HOUSE FOUNDATION WALLS ARE #2 THICK. GARAGE WALLS ARE #2 THICK. (#4 VERTICAL BARS AT 48" O.C., #5 HORIZONTAL BARS ON TOP AND BOTTOM OF WALL)
4. REINFORCING STEEL ASTM A615, GRADE 40
5. DESIGN LOADS ARE:
 ROOF DEAD LOAD - 15 PSF
 SNOW LOAD - 40 PSF
 FLOOR LIVE LOAD - 40 PSF
 FLOOR DEAD LOAD - 25 PSF
 2" TALL #4 VERTICAL DOWELS 2' OC.
 7. FURNACE AND WATER HEATER TO BE VENTED TO CODE

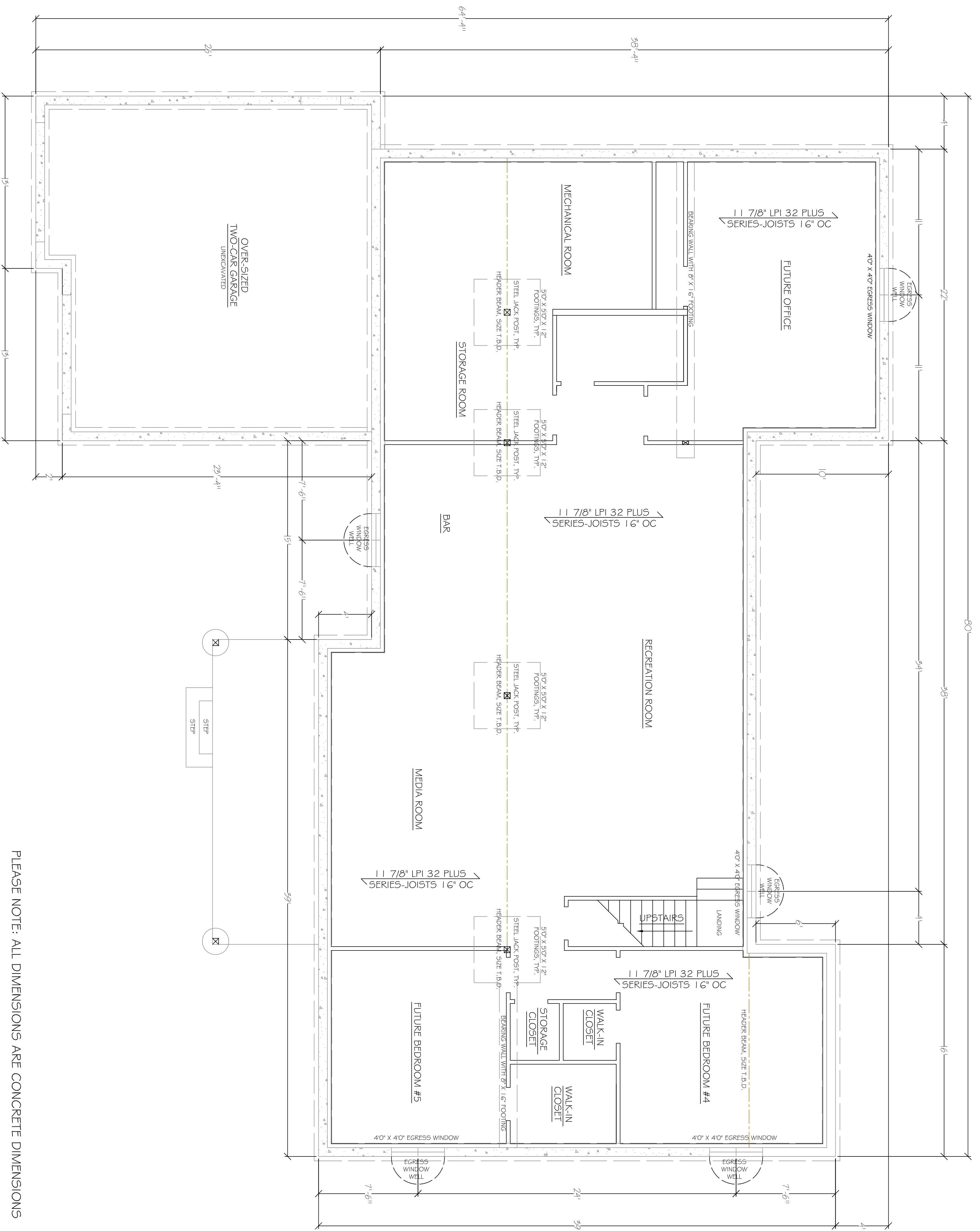

PLEASE NOTE: ALL DIMENSIONS ARE CONCRETE DIMENSIONS



Isaak House Project

Date:	4/27/2007	Drawn By:	
Date Revised:	4/30/2007	Drawn By:	
File Path:	5172007	Drawn By:	
Project Name:	Isaak House	Drawn By:	
Revision:	1	Drawn By:	
Revised Date:		Drawn By:	



BLUEFEATHER
 Design/Build
 Associates, LLC

Marketing Address:
 P.O. Box 4115
 Lawrence, WI 52073
 Phone: 715-432-0336
 Fax: 715-432-0336
 Email: info@bluefeatherdesignbuild.com
 Website: www.bluefeatherdesignbuild.com
 Copyright © 2007
 Reproduction, Distribution, or
 Any Rights Reserved
 www.BluefeatherDesignBuild.com

S.1